

TONG HILL FARMHOUSE TO LET

TONG HILL FARM, HUBBAL LANE,
TONG, SHIFNAL TF11 8PW.



WLT
COMMERCIAL PROPERTY

///supported.losses.lands



NIA c.3,000 sq ft (279 sq m)

This substantial and discrete detached former farmhouse comprises a range of large rooms over two floors. The property is suitable for a variety of uses, subject to planning, being situated in its own grounds adjacent to commercial farm buildings and open agricultural land.

This property, accessible via private driveway, is located on the eastern boundary of Tong adjacent to the A41 and the M54 J3. Albrighton Railway station is 3 miles distant.

We are advised that the Managing Agents, Bradford Estates, are open to discussions to adapt the building as part of an ongoing estate futureproofing, renovation and repurposing exercise.

For further information or to view, please contact Erin Beards on 07534 687232.

Details Created 01/24 - Subject to Contract

WIGGINS LOCKETT THOMPSON LTD

73 High Street, Madeley
Telford, Shropshire TF7 5AH
Tel: 01952 603303/01902 229550
enquiries@wltcommercial.co.uk
wltcommercial.co.uk



Registered address:
73 High Street, Madeley, Telford, Shropshire TF7 5AH
Registered in England & Wales 8686171

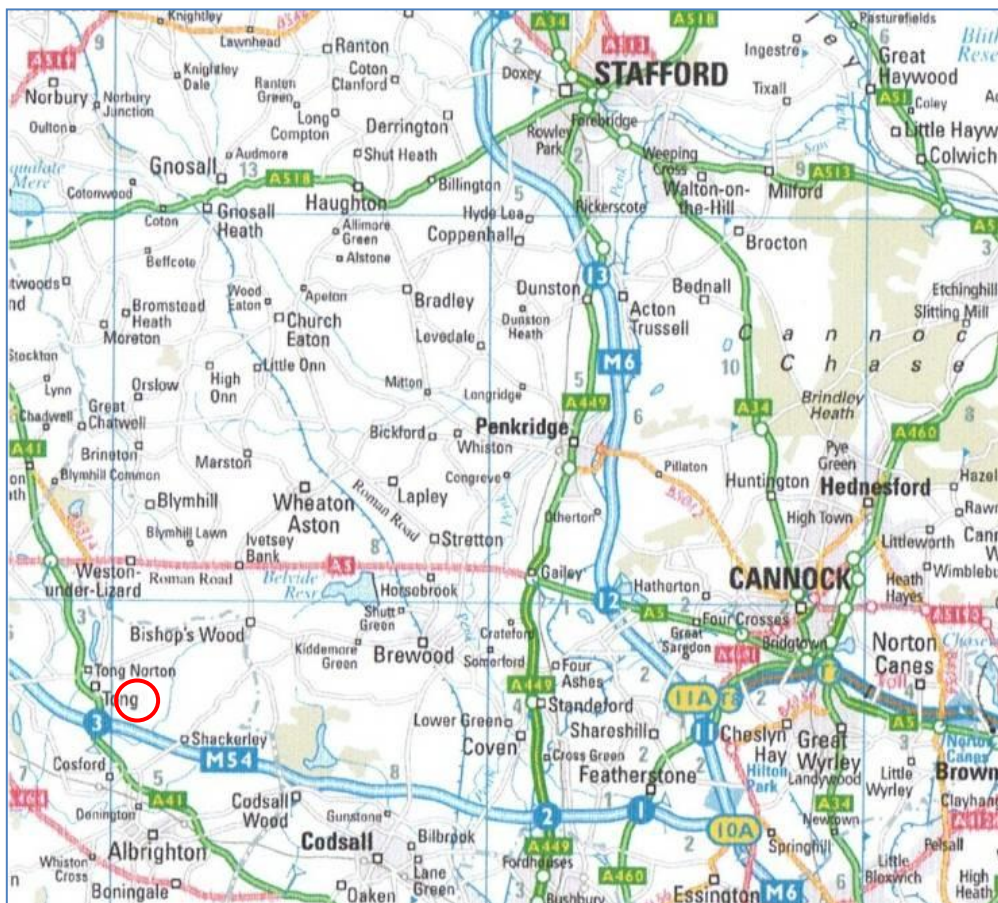
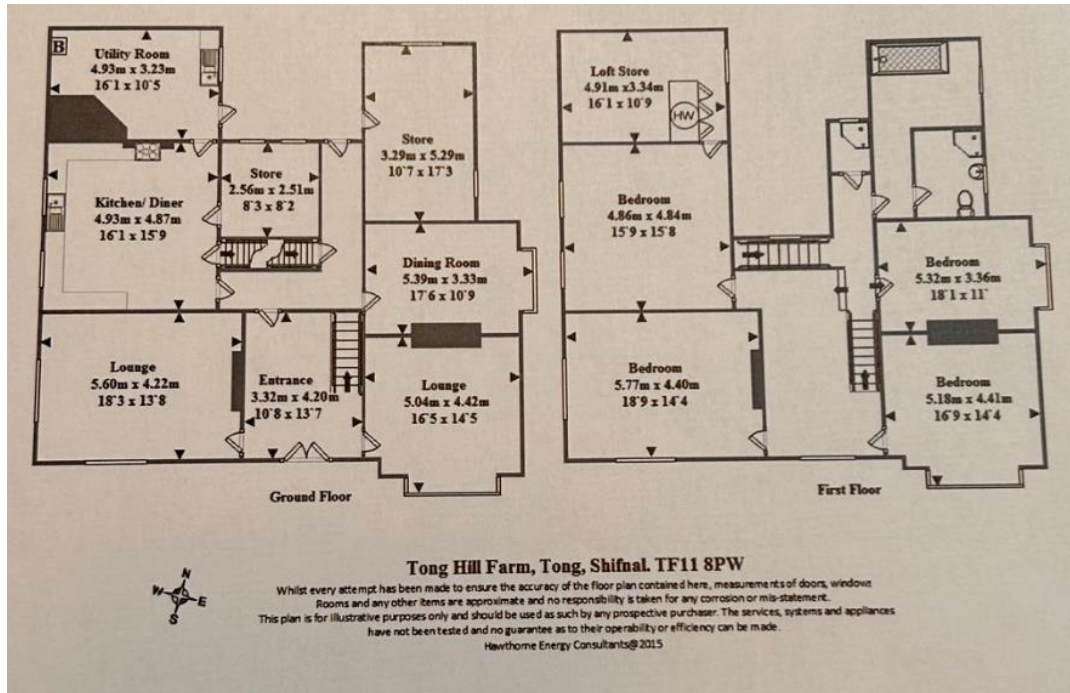

IMPORTANT NOTICE

Wiggins Lockett Thompson Ltd. for themselves and for the vendors or lessors of this property whose agents they are give notice that:

- (i) the particulars are set out as a general outline only for the guidance of intending purchasers or lessees and do not constitute nor constitute part of an offer or contract.
- (ii) all descriptions, dimensions, references to condition and necessary permissions for use and occupation and other details are given in good faith and are believed to be correct but any intending purchasers or tenants should not rely on them as statements or representations of fact but must satisfy themselves by inspection or otherwise as to the correctness of each of them.
- (iii) no person in the employment of Wiggins Lockett Thompson Ltd. has any authority to make or give any representation or warranty whatever in relation to this property.
- (iv) all rentals and prices are quoted exclusive of VAT.
- (v) the reference to any plant, machinery, equipment, fixtures and fittings at the property shall not constitute a representation (unless otherwise stated) as to its state and condition or that it is capable of fulfilling its intended function. Prospective purchasers/tenants should satisfy themselves as to the fitness of such items for their requirements.
- (vi) Any movable contents, fixtures and fittings referred to in these particulars (including any shown in photographs) are excluded from the sale/letting, unless stated otherwise.